



## APPLICATION

NLV Lighting Linear High Bay luminaires are designed for a wide variety of applications for use in warehouses, manufacturing, gyms, parking lots, and other industrial buildings. These fixtures are designed for 15 ft to 40 ft ceilings. The modular design has a full body construction with center driver housing made of Iron shell or Aluminum that provides durability and thermal control. All luminaires come with a diffused lens providing added protection and glare control. These fixtures are energy - efficient replacements for linear fluorescent and HID fixtures.

## FEATURES

- Power Range: 110W to 320W
- Efficiency Range: 130 to 160 LM/W
- **CCT tunable** from 3000K-4000K-5000K
- **Power Selectable** from 110W to 320W
- Operating Temperature: -40oC to 50oC
- Tier-1 LED suppliers; LM80 rated at CRI >80
- 120V to 277V and 120V to 347V; 480V available as option
- PF >0.90, THD ≤ 20%
- Multiple product sizes (L x W): 1 x 1, 2 x 1, and 4 x 2
- Emergency battery back up option
- Motion Sensing and Dimming
- Standard 5 Year warranty

## ORDERING GUIDE

(REGULAR-SERIES)

**Example:** LHB-RSV-135W-40K-347V-160LPW-2X1-DSE-WH

Color Temperature (K)	Input Voltage (V)	Size (ft)	Power (W)	Options
<b>30K</b> - 3000K <b>40K</b> - 4000K <b>50K</b> - 5000K <b>57K</b> - 5700K	<b>277V</b> 120V – 277V	2X1 – (24.7 x 11.8 x 1.9)	110 165	<b>Dimming &amp; Sensing</b> <b>DDM</b> - Dimming <b>DDS</b> – Dimming + Sensing <b>DDE</b> – Dimming + Emergency <b>DSE</b> – Dimming + Sensing + Emergency
		2X1 – (24.7 x 14.2 x 1.9)	220	<b>Color</b> <b>WH</b> –White <b>CC</b> –Custom Color <b>Lens</b> <b>LCA</b> - Clear Acrylic Lens <b>LPA</b> - Prismatic Acrylic Lens <b>Optics</b> <b>General distribution</b> <b>Narrow, Medium, Wide, or Aisle</b>
	<b>347V</b> 120V – 347V	3X1 – (35.7 x 15.2 x 2.1)	320	
		4X1 – (47.5 x 12.8 x 2.1)	220 320	

### ORDERING GUIDE: (HIGH VOLTAGE-SERIES)

**Example:** LHB-RSV-165W-50K-480V-135LPW-2X1-DSE-WH

Color Temperature (K)	Input Voltage (V)	Size (ft)	Power (W)	Options
<b>30K</b> - 3000K <b>40K</b> - 4000K <b>50K</b> - 5000K <b>57K</b> - 5700K	<b>480V</b> 277V – 480V	2X1 - 24.7 x 12.8 x 1.9	110 165	<b>Dimming &amp; Sensing</b> <b>DDM</b> - Dimming <b>DDS</b> - Dimming + Sensing <b>DDE</b> - Dimming + Emergency <b>DSE</b> - Dimming + Sensing + Emergency <b>Color</b> <b>WH</b> -White <b>CC</b> -Custom Color <b>Lens</b> <b>LCA</b> - Clear Acrylic Lens <b>LPA</b> - Prismatic Acrylic Lens <b>Optics</b> <b>General distribution</b> <b>Narrow, Medium, Wide, or Aisle</b>
		2X1 - 24.7 x 15.2 x 1.9	220	
		3X1 - 35.7 x 15.2 x 2.1	320 165	
			220	
		4X1 - 47.5 x 12.8 x 2.1	320	

### ORDERING GUIDE: (TUNABLE-SERIES)

**Example:** LHB-RSV-TPSW-TCT-277V-135LPW-2X1-DSE-WH

Color Temperature (K)	Input Voltage (V)	Size (ft)	Power (W)	Options
<b>30K</b> - 3000K <b>40K</b> - 4000K <b>50K</b> - 5000K <b>57K</b> - 5700K	<b>277V</b> 120V – 277V	2X1 - 24.7 x 12.8 x 1.9	TPS: 110-165-220	<b>Dimming &amp; Sensing</b> <b>DDM</b> - Dimming <b>DDS</b> - Dimming + Sensing <b>DDE</b> - Dimming + Emergency <b>DSE</b> - Dimming + Sensing + Emergency <b>Color</b> <b>WH</b> -White <b>CC</b> -Custom Color <b>Lens</b> <b>LCA</b> - Clear Acrylic Lens <b>LPA</b> - Prismatic Acrylic Lens <b>Optics</b> <b>General distribution</b> <b>Narrow, Medium, Wide, or Aisle</b>
		4X1 - 47.5 x 12.8 x 2.1	TPS: 165-220-320	

### PHYSICAL DIMENSIONS

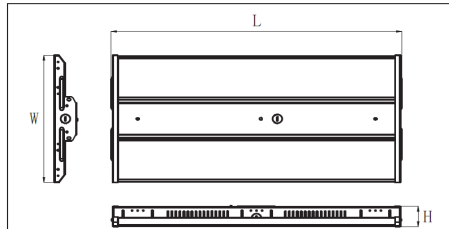

02-110W	24.7*11.8*1.9inch & 24.7*12.8*2.1inch
02-165W	
02-220W	24.7*14.2*1.9inch & 24.7*15.2*2.1inch
03-320W	35.7*15.2*2.1inch
04-165W	47.5*12.8*2.1inch
04-220W	
04-320W	

### PRODUCT OPTIONS

- Standard Dimming 0-10V
- IR/MW motion sensor
- Emergency backup driver from 45-90 minutes lifetime
- CCT and Power tunability
- CCT: 3500-4000-5000K
- Power: 110W-320W

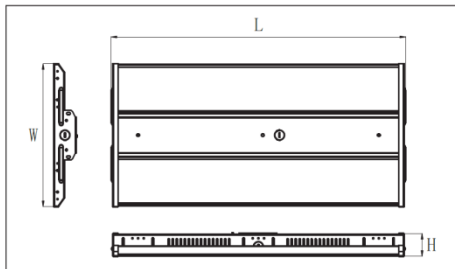





#### Tunable Series – Power and CCT tunability

02-110W/165W/220W	24.7*15.2*2.1inch
04-160W/220W/320W	47.5*12.8*2.1inch

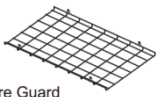

### INSTALLATION ACCESSORIES

 SUSPENDING HOOK	 HANGING CHAIN
 PENDANT MOUNTING BRACKET	 WIRE GUARD
 SURFACE MOUNTING BRACKET	 EMERGENCY-KIT

### ELECTRICAL SCHEMATIC DIAGRAM

#### Without any function, 0(1)-10V Dimming wiring diagram

##### Without any function

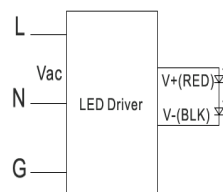

##### 0(1)-10V Dimmer

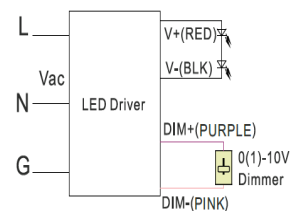

## INSTALLATION - SAFETY NOTICE

The installation of these fixtures shall be done by licensed and qualified contractors only. NLV Lighting shall not held liable for any personnel or property damage.

- Turn power off before inspection, installation, or removal.
- Properly ground all electrical enclosures.
- Follow local codes and all NEC codes.
- Use only UL or IEC approved Wires and other electrical accessories required.
- Check the supply voltage and protect the lighting circuit by 15 -20A circuit breaker.

### INSTALLATION-HANGING CHAIN

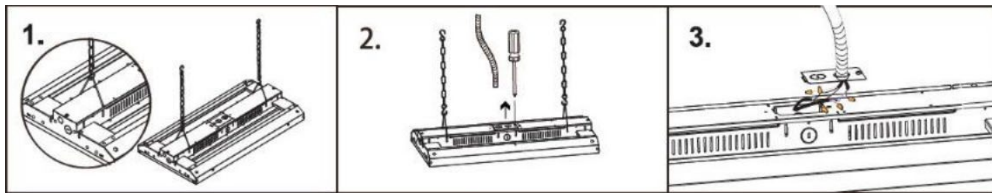

- Take out the lamp and installation accessories. (steel wire\*2 / hanging chain\*2).
- Buckle the steel wire on the chain, then let the steel wire clip into the hole of the power box at the back of the lamp.
- Hanging the chain on the suspending hook to complete the installation.

### INSTALLATION- SCREW MOUNT

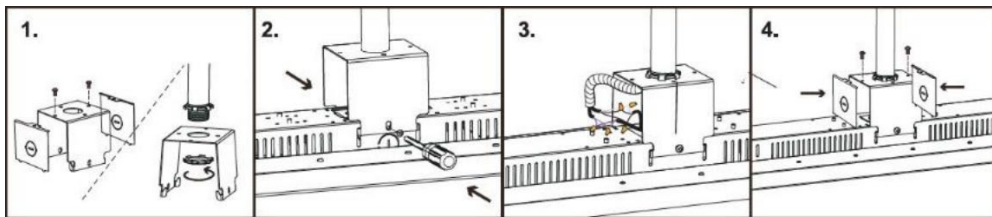

- Take out the lamp and installation accessories. (ceiling box/ circular pipe/ i-type bracket/ gasket I spring/ gasket/ nut\*2 / screw\*3) first fix the ceiling base on the wall with screws, then screw the circular pipe on the ceiling base, and then screw the nut on the circular pipe.
- First put the i- bracket on the circular pipe, then fixed with gasket/ spring gasket and nut.
- Stuck the lamp on the i-bracket to complete the installation.
- Align the studs of the side plate with the slots in the housing, set up the side plates, and fix them with screws.

### INSTALLATION-CEILING MOUNT

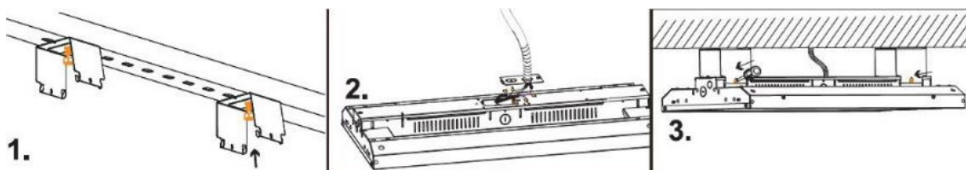

- Take out the lamp and installation accessories. (i-type bracket/screw\*4).
- Fix the i-bracket on the power supply with 4 screws.
- Assemble the lamp on the i-bracket to complete the installation.